

**INSIDE
OUT
RV**

KAI IWI 640B

21' | 4/5/6 BERTH | 2 OR 3 BUNKS

Family
bunk

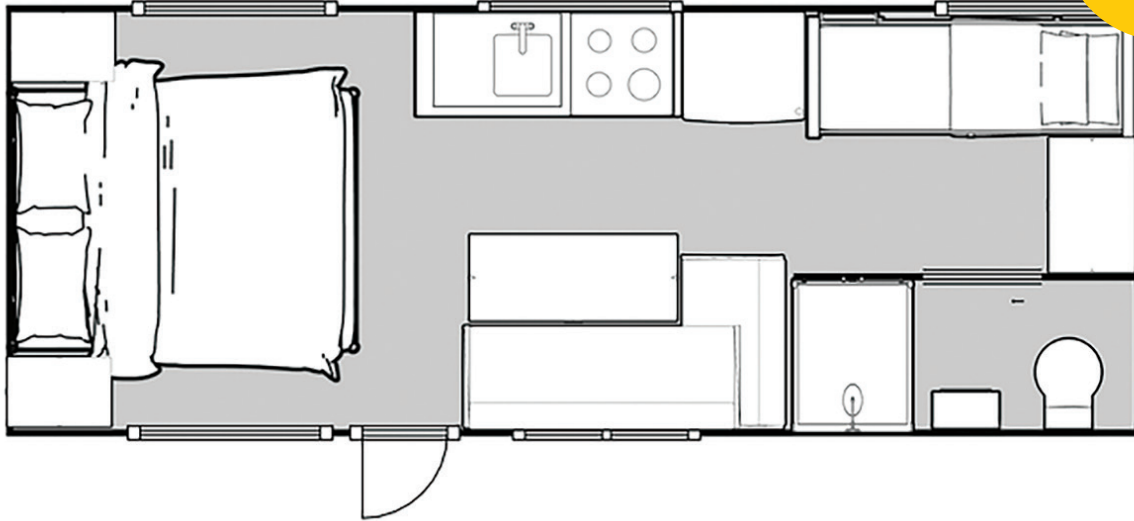

CARAVAN LENGTH: 21' / 6.4m **OVERALL LENGTH:** 8m **HEIGHT:** 2.9m **WIDTH:** 2.45M
WEIGHT: 2500kg (approx.) **PAYLOAD:** 700kg (approx.) **ATM:** 3200kg



INSIDEOUTRV | 08002INSIDE | SALES@INSIDEOUTRV.CO.NZ

KAI IWI 640B EXTERIOR DETAILS

UPGRADES AVAILABLE

| | | | |
|---------------------------|--|--|--|
| Length | 6.4m, 21' (8m including drawbar) | Add 300mm in length | |
| Width | 2.45m | | |
| Chassis | Hot dip galvanised | Painted pre-galvanised | |
| Suspension | Roller Rocker 3200KG (tandem axle) with shockers | Independent suspension; airbags, etc | |
| Brakes | 10", electric drum brakes | Redarc Towpro brake controller in car | |
| Wheels | 15" alloy, 6 stud 235/75 | 16"; wheel spats; coloured wheels | |
| Coupling | Standard 50mm ball | DO35; others on request | |
| Tare weight | 2500kg (approx.) | | |
| Ball loading at tare | 240kg (approx.) | | |
| ATM | 3200kg | | |
| Rear bumper | 4 arms, with spare wheel bolted on | 2 arm; spare wheel underslung | |
| Water tanks | 2x 95l, monitored | Up to 4x total (including grey water) | |
| Grey water tank | 1x 95l, monitored | Up to 4x total (including fresh tanks) | |
| Gas bottles | 2x 9kg Cradles (one bottle included) | Enclose in front toolbox | |
| Entry step | Manual aluminium step | Electric step | |
| Battery | 2x 100Ah battery in metal box on chassis | Increase Ah; increase number; upgrade to lithium | |
| Battery management system | Standard (basic) | Redarc Manager 30; Redarc RedVision; Others on request | |
| Windows | Ranger windows, with integrated concertina fly mesh & blinds | Front window, +/- protector shield | |
| Entry door | Dometic, black, with lockable security mesh | | |
| Checker plate | Black, 570mm high | Silver checkerplate (no charge) | |
| Exterior cladding | Aluminium composite panelling – charcoal, silver or white | Upgrade to full colour range. Scale back to aluminium corrugate cladding | |
| Decals | Your choice of colours | | |
| Insulation | Full (walls and roof) | Insulated floor panel | |
| Roof hatches | 3x 450x400 | 4x; or increase size to 700x500 | |
| Power (fan) hatches | 1x 324x324 | | |
| Exterior picnic table | 800x450 with LED light | Additional picnic table(s) | |
| Awning | Dometic 8300, Granite + cradle | Customer supply | |
| Tunnel boot | 1x full, at front of van | | |
| Exterior lights | 3x LED, 1x door handle light | Additional lights on front and rear | |
| External power points | 1x 240v, and 1x 12v | | |
| Car trailer plug | 12 pin & Anderson plug | Change to 7 pin if suitable | |
| Solar panels | 2x 170w | Up to 5x 170w | |
| Reversing camera | Wired camera, with monitor for in car | Wireless options on request | |
| Emergency brakes | Standard electric breakaway system | | |
| Power inlet | Black flush mounted 16v power inlet | | |
| External shower | Yes, hot and cold with exterior light | | |
| External tap | Yes, on A-frame | | |
| BBQ gas point | Yes, Bayonet | | |

UPGRADE YOUR ADVENTURE

INSIDEOUTRV | 08002INSIDE | SALES@INSIDEOUTRV.CO.NZ

KAI IWI 640B INTERIOR DETAILS

UPGRADES AVAILABLE

| | | | |
|------------------------------|---|--|--|
| Stove | 4x gas stove, grill, and oven | Fanforced; stove and grill only. Outdoor kitchens available | |
| Rangehood | Ranger 12v, flush mount | | |
| Fridge | Dometic 3 way fridge RUA6408x (190l) | Dometic RUC6408x compressor (12v) Increase capacity to (216l) Other options available on request | |
| Audio/Video | USB/AUX/Bluetooth/Radio with 2x internal and 2x external speakers | Upgrade options available | |
| Heater | Diesel heater, one outlet | Gas heater; Air conditioning | |
| Internal lights | LED | | |
| Hot water system | Swift gas & electric | Continuous hot water system, Truma combi system | |
| Water pump | 12v | | |
| Shower | Large 750 x 900, with easy entry, sliding opaque glass door. Chrome shower slide | Upgrade to black shower slide | |
| Toilet | Dometic Swivel toilet, with china bowl. 16l waste cassette | | |
| Bathroom | Chrome tapware, white countertop square sink | Upgrade to black tapware | |
| Cupboard colours | Your choice of colours | | |
| Benchtop & tabletop | Your choice of laminate | | |
| Splashback | Your choice of colours | | |
| Vinyl flooring | Your choice of vinyl | | |
| Upholstery | Your choice of leatherette | Upgrade to full colour range (no charge) | |
| Cupboard hinges | Household standard x2 | | |
| Overhead cupboard handles | Concealed latches with 2x gas struts | | |
| Lower cupboard handles | Your choice of handles | | |
| Mattress | Queen size, pillow top mattress | Bolster mattress (for shorter day bed) | |
| Wardrobes | Cubbyholes, with power points/12v inside. Shelves or hanging robes | | |
| Pantry | Full height with slide out modules | | |
| Table | Fully adjustable table (nuovo mapa), that converts to an additional bed | | |
| Master bed | Queen bed, with pillow-top mattress | | |

OTHER POPULAR ADD-ON'S

| | | |
|-------------------------------------|---|--|
| Front toolbox | On drawbar, for gas bottle and other storage. (Includes 2x slides, and drawbar extension of 350mm) | |
| BBQ slideout, or Outdoor kitchen | In front tunnel boot, near gas point | |
| Bike rack | Adaptor for bike rack that attaches to rear bumper | |
| Microwave | In overhead cupboard in kitchen | |
| Washing machine | Top loader or front loader | |
| Black Pack | Upgrade to black tapware, kitchen sink, and shower slide | |
| Increase headroom | Raise height of caravan by 50mm overall | |
| TV & antenna | Your choice & cost. Fitted in NZ. (Visit www.rse.co.nz) | |



WARRANTY

Structural chassis: 5 years
Body/build: 3 years
Appliances: manufacturer's warranty
Specifications correct at time of printing.
Subject to change.



**INSIDE
OUT
RV**

[f](#) [@](#) [@insideout.rv](#)

Join the INSIDEOUTRV INSIDER FB group!

INSIDEOUTRV | 08002INSIDE | SALES@INSIDEOUTRV.CO.NZ